

HS20A-1000-Z4LT-D

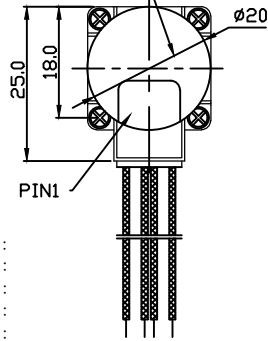

Vcc (5V) :
Gnd :
A+ :
A- :
B+ :
B- :
Z+ :
Z- :

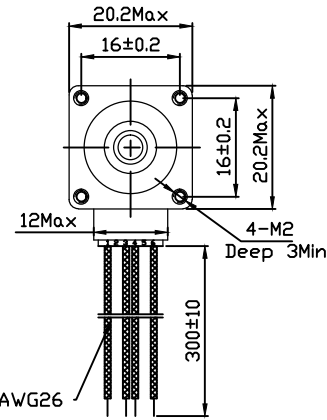
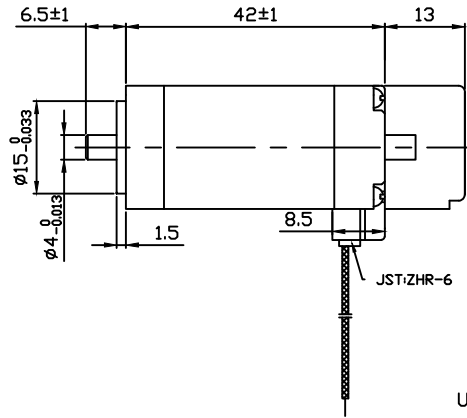

REV	ECN NO.	DESCRIPTION	DRN	APP'D	DATE

Wiring Diagram

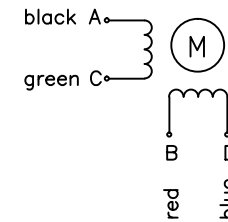

CW DIRECTION	STEP	A	C	B	D
↓	1	+		+	
	2		+	+	
	3		+		+
	4	+			+
	1	+		+	

CW see from the flange side

SPECIFICATION

STEP ANGLE	1.8°/full step	PERMISSIBLE RADIAL+AXIAL FORCE	
STEP ANGLE ACCURACY	±5%	SPRING WASHER	
NUMBER OF PHASE	2		
RATED VOLTAGE	4.32 VDC		
RATED CURRENT	0.8 A	BEARING	
RESISTANCE/PHASE	5.4±10% ohms@20°C		
INDUCTANCE/PHASE	1.5±20% mH@1kHz		
HOLDING TORQUE	300 g.cm		
PULL OUT TORQUE			
BACK EMF			
DETENT TORQUE			
ROTOR INERTIA	3.6 g.cm ²		
WEIGHT	80 g		
TEMPERATURE RISE	Less than 80K	AXIAL-FORCE	Fa=4N Max.
SOURCE VOLTAGE	24 VDC	DISTANCE	a=5mm
INSULATION CLASS	B 130°C	RADIAL-FORCE	Fr=10N Max.
DIELECTRIC STRENGTH	500VAC 1Min		
INSULATION RESISTANCE	100M0hm @500VDC	SHAFT RADIAL PLAY	0.02mm Max. Ø4N
IP CODE	IP30	SHAFT AXIAL PLAY	0.08mm Max. Ø4N
OPERATION AMBIENT	Ambient temperature:-20...+50°C, humidity Max. 85%(No condensation)		
STORAGE AMBIENT	Ambient temperature:-20...+85°C, humidity Max. 85%(No condensation)		

DESIGN	DATE	P/N.	TITLE
			Specifications
UNLESS OTHERWISE SPECIFIED TOLERANCES:			USED ON
DECIMALS:	ANGULAR:		DWG NO.
.x ±0.5	±0°30'		REV
.xx ±0.25			
.xxx ±0.1			
UNIT: mm	FIRST ANGLE PROJECTION	SCALE NTS	MST082A393WAE2.80Q
DO NOT SCALE DRAWING		SHEET OF	