

Unit: MM

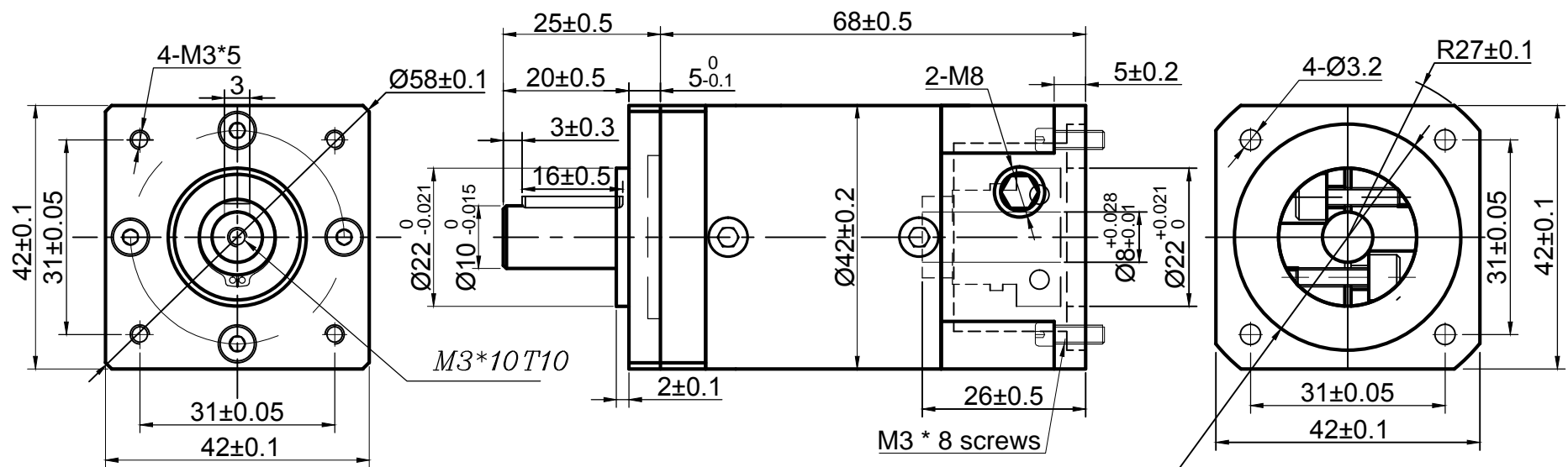

Rated output torque: TN Nm  
 Failure to stop the torque: 2 TN Nm  
 Rated input speed: 3000 / RPM  
 Maximum input speed: 6000 / RPM  
 Installation method: arbitrary  
 The average life expectancy: 20000 h  
 Weight: 0.42 Kg  
 Maximum radial force: Fr = 80 Nm  
 Maximum axial force: Fa = 30 Nm  
 Dust-proof cover ball bearing, type: 6900RS,  
 internal diameter 10, external diameter 22, thickness: 6.  
 Output shaft key criteria: round head ordinary flat key (J) GB1096-79  
 The above parameters suitable for standard type reducer,  
 non-standard models are for reference only.  
 With motor size: Ø8 \* 25 / 42- Ø22 / F31 \* 31-4-2 M3 \* 8

The moment of inertia:  
 Full load efficiency: 94%  
 Working temperature: 25 ° ~ 90 °  
 Grease lubrication way: synthesis (long-term lubrication)  
 Flange precision: DIN 42955 - R  
 Return clearance: < 30 arcmin  
 (according to the rated service life, the output speed is  
 100 RPM output shaft length 1/2 point for loading point)

Ø36  
 (hole gap <sup>+0.025</sup>/<sub>0</sub>; shaft <sup>0</sup>/<sub>-0.025</sub>)

Input shaft diameter	The input shaft sleeve
Ø8	
Ø6.35	8-6.35
Ø5	8-5

model	Transmission ratio	Rated output torque TN(NM)
HSHG17N020MHN17008M	20:1	12

Designer	File No.	Signature	Date	Ratio
				2 / 1:1
Modifier				
Auditor				
Approver				

